

# FUEL FILTER

COMPONENT EAACC008

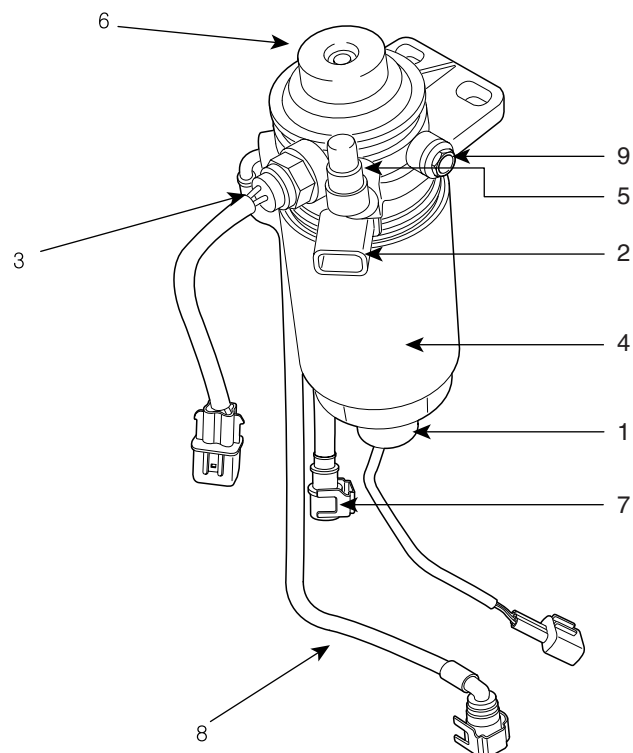

- 1. Water Sensor
- 2. Heater
- 3. Thermo Switch
- 4. Fuel Filter Cartridge

- 5. Air plug (for plant)
- 6. Manual pump
- 7. Inlet hose
- 8. Outlet hose
- 9. Air plug (for service)

## FUEL DELIVERY SYSTEM-DIESEL

FLA 13

### REMOVAL

EA5F487B

1. Turn ignition switch to OFF position.
2. Disconnect the negative battery (-) terminal and wait for about 30 seconds.
3. Unscrew the two mounting bolts(A).

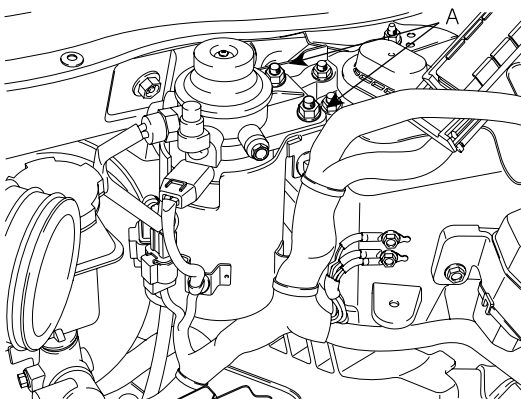

LGJF503H

4. Disconnect the heater connector (B), water sensor connector (C) and thermo switch connector (D).

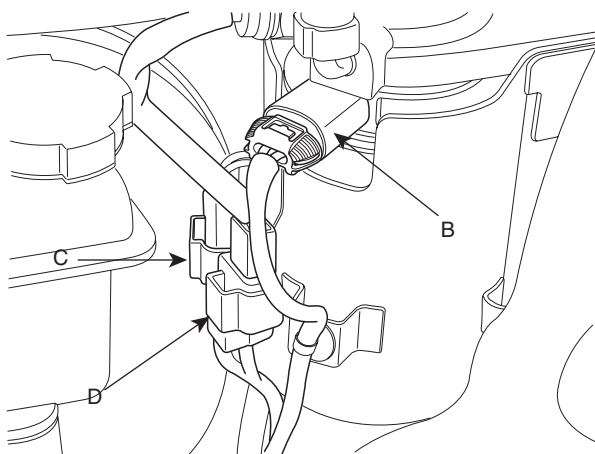

AWJF302U

5. Remove air cleaner assembly (Refer to "EM" group).

6. Disconnect the fuel inlet hose (E) and fuel outlet hose (F).

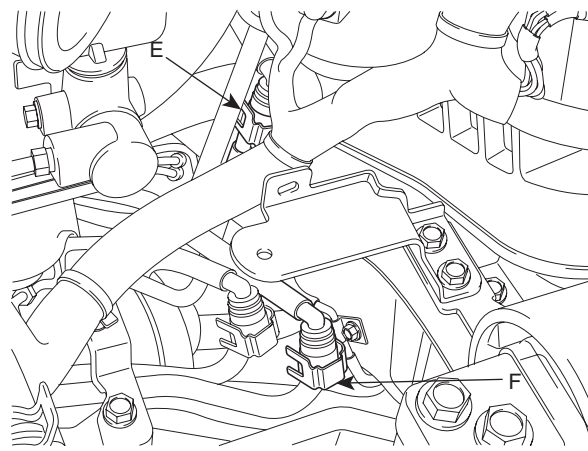

AWJF302V



### CAUTION

**Cover the hose connection with a shop towel to prevent splashing of fuel caused by residual pressure in the fuel line.**

7. Remove the fuel filter assembly.

### INSTALLATION

EF48CC57

1. Connect the fuel inlet hose(A) and fuel outlet hose(B).

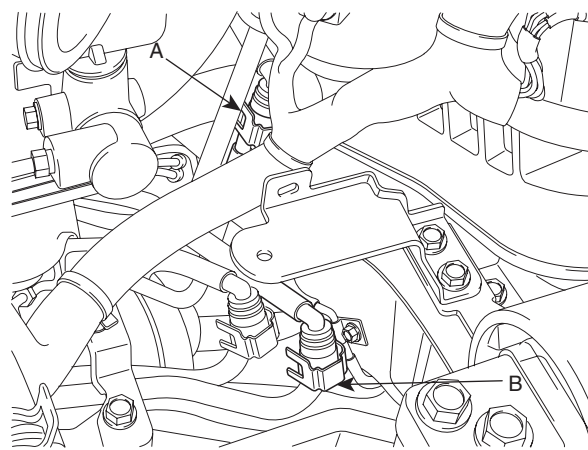

AWJF302W

2. Remove air cleaner assembly (Refer to "EM" group).

3. Connect the heater connector(C), water sensor connector(D) and thermo switch connector(E).

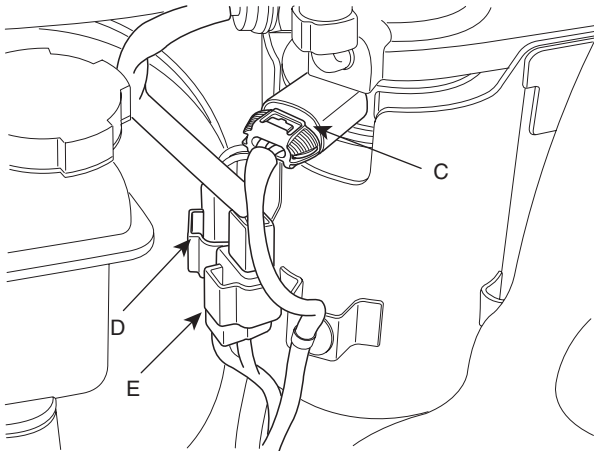

AWJF302X

4. Fasten the two mounting bolts(F).

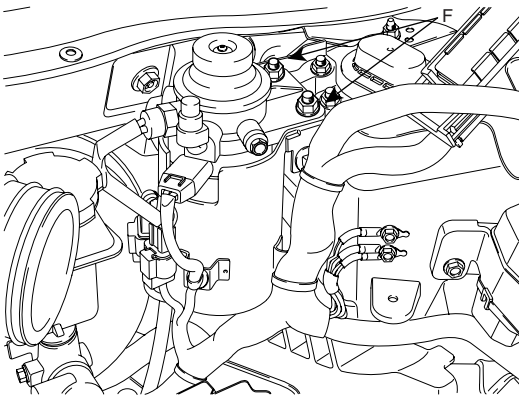

LGJF503J

- Fuel filter deflation.
  - a) Remove the air plug(I) of fuel filter.
  - b) Cover the air plug with service towel, and then push the manual pump(J) until a bubble dose not flow out.
  - c) Faten the air plug(I), and then push the manual pump again until pushing the manual pump gets to be difficult.
- Pulling out water from fuel filter.
  - a) Unfasten the drain plug(K).
  - b) Push the manual pump(J) until water dose not flow out.
  - c) Fasten the drain plug(K).

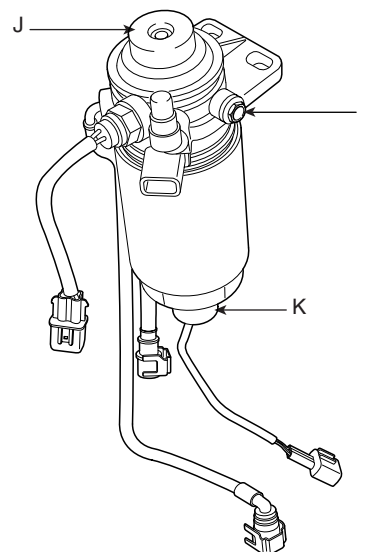

LGJF503I

5. Connect the negative(-) terminal.
6. Start the engine and check for leakage on fuel line connected to fuel filter.

## INSPECTION EC40ED42

- General insepction.
  - a) Hose and pipe for bent, damage, clogging or corrosion.
  - b) Fuel filter for cologging and damage.



### NOTE

- The fuel filter inspection must be completes in case of below.
  - a) Draining fuel in fuel tank and then refilling fuel.
  - b) Replacing the fuel filter.
  - c) Removing the main fuel hose (pipe).